

Smart Jump Rope

Quick Start Manual

Product Introduction

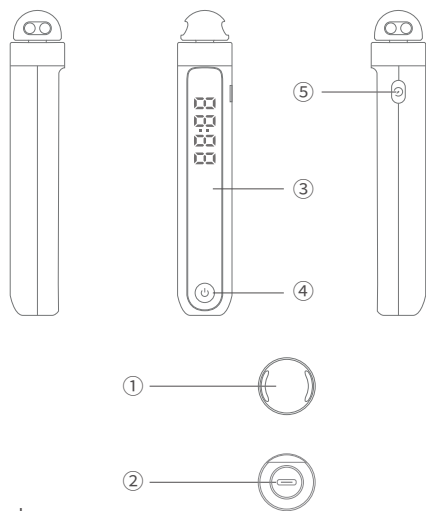

Remark:

- ① Top cover
- ② Type-C charging port
- ③ Main housing
- ④ Power button
- ⑤ Mode shift button

Basic Parameter

Product Name: Smart Jump Rope

Material: Handle bar ABS, Rope PVC

Rope Size: 3M, diameter 5mm

Maximum record: 9999

Input Voltage: 5V, 200mA

Battery Capacity: 300mAh

Connector Type: Type-C

Power Supply: Rechargeable Li-ion battery

Working Temperature: -10~45°C

Installation Method

1. Rope passes through the closed round hole of the buckle first, and then through the hole on the top cover of the handle.
2. Rotate the rope and pass through the hole on the other side of the cover on the top of the handle.
3. When rope inserted into or passed through the hole of the buckle, one handle and rope assembly finish. The fixed position of the buckle can be adjusted according to your own usage habits. Just complete the assembly of the handle and rope on the other side as instruction.

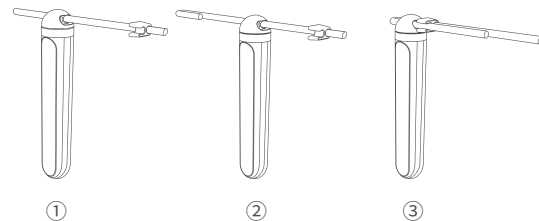

Operation Instruction

1. Power button

- ① Hold power button for 2s, display “88:88” means power on successfully.
- ② Hold power button for 3s, display “OFF” means power off successfully.
- ③ "----" represents full battery, battery reduce every 25%, a "-" will be reduced, and the low battery will display "Lo".
- ④ Short press power button 2 times to reset data to 0.

2. Mode Shift button

- ① Short press shift button to select countdown time, “01:00”, “02:00” or “03:00”.

3. Button Shift

- ① Countdown mode: When countdown finish, reset countdown mode by short press power button 2 times.
- ② Countdown mode: When countdown not finish, reset countdown mode by short press power button 2 times.
- ③ Free exercise mode: When start or finish jumping, change between exercise time and skipping numbers mode by short press mode shift button.

Install Smart Life App

Scan the QR code with your mobile phone, or search for Smart Life in the app market, download and install the App.

- ❗ If your mobile phone has downloaded Smart Life App, please make sure that the App version is the latest.



Smart Life App

Connect Device

- 1.Connect your mobile phone to home wireless network.
 - 2.After jump rope power on, it enter Bluetooth pairing connection mode by default.
 - 3.Click Smart Life App on your phone, when using it for the first time, please register/log in to your account according to the app guidelines.
 - 4.Go to the home page of the App, click "+" and select "Auto Discovery", the App will search for the smart device to be configured, and add the device according to the App interface prompts.
- ❗ If the device is not found, click "Add manually" at the top of the scan page, and manually add the device according to the interface prompts.

Caution

- This product is not waterproof, please do not use it outdoors in rain.
- To avoid damage, pay attention to plugging and unplugging when charging.
- When wiping the handle, use a dry cloth, do not get wet.
- Please carefully evaluate your own condition before skipping and do a warm-up exercise.
- Keep the product out of reach of infants and young children.
- This product cannot be used while charging. After charging is complete, unplug the charger. Do not charge all the time.
- When not in use, place it in a dry and ventilated place, and keep it away from heat sources or liquid areas.